

## PRINTABLE INFO SHEET

**Series: Westlake Sapphire**  
**Model: 1W1407-V Sapphire**



## About This Model

**Style: Single / Bedrooms: 3 / Bathrooms: 2 / Square Feet: 1140**

## CUSTOMER CONTACT

Notes:

---

---

---

---

## PRINTABLE INFO SHEET

Series: Westlake Sapphire

Model: 1W1407-V Sapphire



## Floorplan

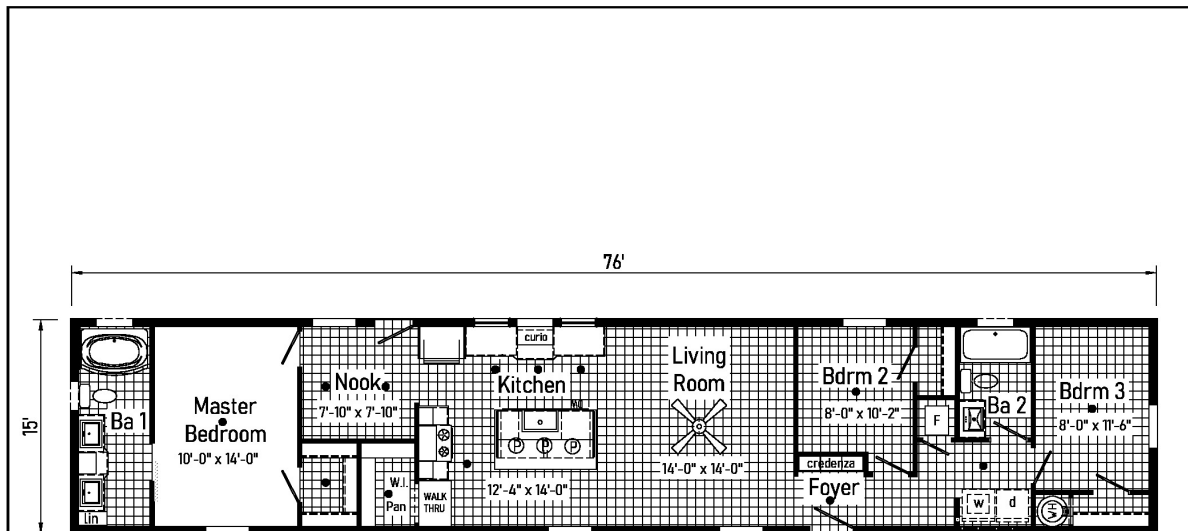

1W1407-V 1676 Approx. 1140 Sq. Ft.

Westlake Sapphire

|                           |   |               |            |                      |        |         |                                  |
|---------------------------|---|---------------|------------|----------------------|--------|---------|----------------------------------|
| Builder: midcountry Homes | Address: 337 Liberty Street<br>Dorchester, WI 54425 | Callout: 1676 | Revisions: | Scale: 1"=0" = 1'-0" | Date:  | Cust: - | Model/Eng. No.: 1W1407-V<br>LIT2 |
| Title: Literature         |   |               | Drawn By:  | Reference: NONE      | Dir: - | S/N: -  | Pg.:                             |

N:\MIDCOUNTRY\1W1407-V\1676-16

## CUSTOMER CONTACT

Notes:

---

---

---

---

## PRINTABLE INFO SHEET

**Series: Westlake Sapphire**

**Model: 1W1407-V Sapphire**



## Standards & Features

### Interior

Primed Drywall Throughout Orange Peel Finish  
8'-0" Flat Ceiling Orange Peel Finish  
Recessed LED Lights  
Pendant Dining Room Light  
2-Panel White Painted Craftsman Interior Doors  
Pre-Hung Doors with Mortise Hinges  
Metal Interior Passage Sets  
Window Valances  
1" Mini Blinds Throughout  
Smoke Detectors with Battery Back-Up  
Wire Shelving in Closets  
White Painted Mouldings Throughout  
Flat 2 1/4" Window and Door Casing  
Flat 3 1/2" Baseboards

### Exterior

Black Gatsby Light at Front and Rear Door  
Vinyl Dutch Lap Siding  
Vinyl Insulated Windows with Low-E Glass  
Lineals Front Door Side  
GFI-Protected Exterior Receptacle at Each Door  
O.S.B. Wall & Roof Sheathing Fixed Roof  
12" Overhangs and Eaves (Ranch)  
4" Overhangs and 12" Eaves (Single)  
3-Tab Shingles  
Ridge Vent Roof Ventilation System  
Ice Shield  
3/0x6/8 Fiberglass 6-Panel Front and Rear  
Door w/ Deadbolt Keyed Alike Locksets

### Construction

Transverse Floor System on 16" Centers\*

### Construction (continued)

3/4" OSB Decking\*  
2x6 Floor Joist on 14 and 28 Wide Models  
2x8 Floor Joists on 16 and 32 Wide Models  
2x6 Exterior Walls on 16" Centers\*  
82" Window Headers  
30# Roof Load

### Kitchen

Empire Brushed Nickel High Rise Faucet  
Stainless Steel Sink 33x22x8  
One USB Receptacle  
30" Black Free-Standing Gas Range  
Power Range Hood with Fan and Light  
18 Cu. Ft. Black Frost-Free Refrigerator w/Top Freezer

### Baths

60" Fiberglass Tub/Shower Tub/Shower Curtain and Curved Rod  
Dual Flush Elongated Hi-Rise Toilets  
China Stool, Tank, and Lid  
Square China Sinks with Overflow and Pop-Up Drain  
Bevel Edge Mirrors  
Empire Brushed Nickel Faucets  
Anti-Scald Valves on Showers and Tubs

### Cabinetry

KCMA Certified Cabinets  
Hardwood Wrapped Mission Cabinet Doors with Full Overlay  
Hardwood Wrapped Cabinet Face Frames and Stiles  
5-Piece Drawer Fronts  
Brushed Nickel Cabinet Pulls Hardware  
Soft Close Hidden Cabinet Hinges  
Base & Wall Cabinets with Adjustable Shelves

## CUSTOMER CONTACT

Notes:

---

---

---

---



## PRINTABLE INFO SHEET

**Series: Westlake Sapphire**

**Model: 1W1407-V Sapphire**



## Standards & Features (continued)

### Cabinetry (continued)

100# Undermount Soft Close Drawer Guides

Laminate Countertops with Crescent Edge

4" Laminate Backsplash

36" High Vanities

### Bedrooms

Wire Shelving in Closets

Switched Light in All Walk-In Closets

### Flooring

Take Away Shaw Carpet with ShawGuard Carpet Protector

Rebond Carpet Pad with Tackstrip Carpet Installation

Shaw Vinyl Floor Coverings

### Utilities

100 AMP Electrical Service

Plumb and Wire for Washer

Wire and Vent for Dryer

Water Shut Offs Throughout

Main Water Shut-Off

One Exterior Water Faucet (Frost Free)

30 Gallon Electric Water Heater with Pan

Gas Furnace

5-Wire Thermostat

Copper Wiring Throughout

### Insulation

Ceiling R-30 Avg. Blown Insulation

Walls R-19 Fiberglass Insulation

Floor R-11 Fiberglass Insulation

**Items in bold are the Sapphire Additional Features**

### **8'-0" Cathedral Ceiling (Multi Sections)**

Skyview Wall with Transoms

Ceiling Fan in Living Room

### **8'-0" Cathedral Ceiling (Multi Sections) (continued)**

Foyer Accent Cabinet and Wall

3 Pendant Lights over Island

Pearl Appliance Package Stainless Steel Gas

Stainless Steel Over the Range Microwave

Full Ceramic Backsplash on Range Wall

Sliding Interior Door in Nook

Additional LED Lights in Nook

Accent Cabinet

30" Galley Sink w/ Spring Pull Out Faucet

Garden Tub/Shower in Master Bath

Double Sinks in Master Bath

2 Light Bath Fixtures Over Lav Mirrors

Accent Cabinet

**\*\*Spacing for Framing Members may vary  
due to Design Requirements**

## CUSTOMER CONTACT

Notes:

---

---

---

---