

# PRINTABLE INFO SHEET

Series: Westlake Retreats  
 Model: 1W1903-V Outlook

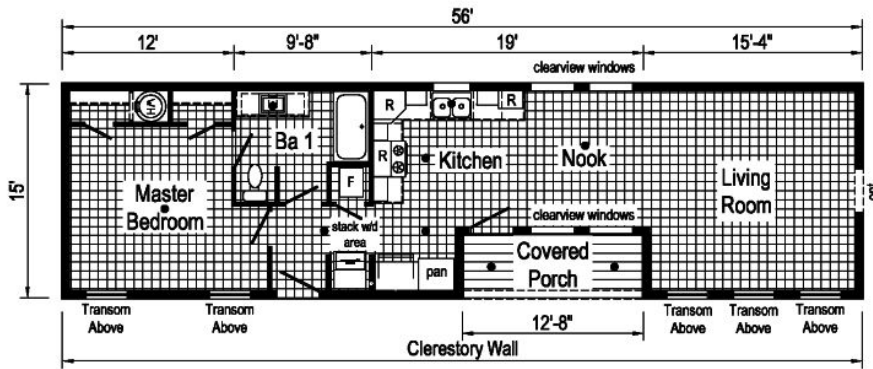

1W1903-V 1656 Approx. 783 Sq. Ft.

R = Std. 30/36 staggered overhead  
 ● = Std. can light

Westlake Retreat  
 Outlook

Builder: midcountry homes	Callout: 1656	Revisions: Date: 11/14/18 Number: 2/22/19	7/30/20 10/1/20	Scale: 1/8" = 1'-0"	Date: 10/10/2018	Client: -	Model/Eng. No.: 1W1903-V
Title: Literature				Drawn By: OY	Reference: NONE	Dir: -	LIT
						SIN: ---	Pg: 1

## About This Model

Style: Single / Bedrooms: 1 / Bathrooms: 1 / Square Feet: 783

## CUSTOMER CONTACT

Notes: \_\_\_\_\_  
 \_\_\_\_\_  
 \_\_\_\_\_  
 \_\_\_\_\_

# PRINTABLE INFO SHEET

**Series: Westlake Retreats**  
**Model: 1W1903-V Outlook**



## Standards & Features

### Interior

- Primed Drywall Throughout - Orange Peel Finishes..
- 8'-0" Flat Ceiling - Orange Peel Finish
- Recessed LED Lights
- Black Dining Room Light
- 2-Panel White Painted Craftsman Interior Doors
- Pre-Hung Doors with Mortise Hinges
- Metal Interior Passage Sets
- Window Valances
- 1" Mini Blinds Throughout
- Smoke Detectors with Battery Back-Up
- Wire Shelving in Closets
- White Painted Mouldings Throughout
- 2 1/4" Window and Door Casting

### Exterior

- Black Lantern Light at Front and Back Door
- Vinyl Dutch Lap Siding
- Vinyl Insulated Windows with Low-E Glass
- Lineals Front Door Side
- GFI-Protected Exterior Receptacle at Each Exterior Door
- O.S.B. Sheathing
- Fixed Roof
- 12" Overhangs and Eaves
- 3-Tab Shingles
- Ridge Vent Roof Ventilation System
- Ice Shield
- 3/0x6/8 Steel 6-Panel Front and Rear Door-w/ Deadbolt Keyed Alike Locksets

### Construction

- Transverse Floor System on 16" Centers with 3/4" OSB Decking\*\*

### Construction (continued)

- 2x6 Floor Joist on 14 and 28 Wide Models
- 2x8 Floor Joist on 16 and 32 Wide Models
- 2x6 Exterior Walls on 16" Centers
- 82" Windows Headers
- 30# Roof Load

### Kitchen

- Empire Brushed Nickel High Rise Faucet Fixture
- Stainless Steel Sink 33x22x8
- One USB Receptacle
- 30" Free-Standing Gas Range
- Power Range Hood with Fan and Light
- 18 Cu. Ft. Frost-Free Double Door Refrigerator

### Baths

- 60" Fiberglass Tub/Showers
- Tub/Shower Curtain and Curved Rod
- 1.6 Gallon Per Flush Elongated Toilets
- China Stool, Tank, and Lid
- Square China Sinks with Overflows and Pop-Up Drains
- Bevel Edge Mirrors
- Empire Brushed Nickel Faucets
- Anti-Scald Valves on Showers and Tubs

### Cabinetry

- KCMA Certified Cabinetry
- Premium Mission Cabinet Doors with Fill Overlay
- Premium Cabinet Face Frames and Stiles
- Brushed Nickel Cabinet Hardware
- Hidden Cabinet Hinges
- 30"/36" Staggered Overhead Cabinets
- Base and Wall Cabinets with Adjustable Shelves
- 100# Undermount Soft Close Drawer Guides

## CUSTOMER CONTACT

Notes:

---

---

---

---

## PRINTABLE INFO SHEET

**Series: Westlake Retreats**  
**Model: 1W1903-V Outlook**



## Standards & Features (continued)

### Cabinetry (continued)

Laminate Countertops with Crescent Edge  
4" Laminate Backsplash  
36" High Vanities

### Bedrooms

Wire Shelving in Closets  
Switched Light in All Walk-In Closets

### Flooring

Mantra Shaw Carpet- with ShawGuard Carpet Protector  
Rebond Carpet Pad with Tackstrip Carpet Installation  
LuxFlor No-Wax Vinyl Floor Coverings

### Utilities

100 AMP Electrical Service  
Plumb and Wire for Washer  
Wire and Vent for Dryer  
Water Shut Offs Throughout  
Main Water Shut-Off Valve  
One Exterior Water Faucet  
30 Gallon Electric Hot Water  
Heater with Pan  
Air Ready Gas Furnace  
5-Wire Thermostat  
Copper Wiring Throughout

### Insulation

Floor R-11 Fiberglass Insulation  
Walls R-19 Fiberglass Insulation  
Ceiling R-30 Avg. Blown Insulation  
\*\*Spacing for Framing Members may vary  
due to Design Requirements

## CUSTOMER CONTACT

Notes:

---

---

---

---