

## PRINTABLE INFO SHEET

Series: Westlake MOD

Model: 3WM1643-P

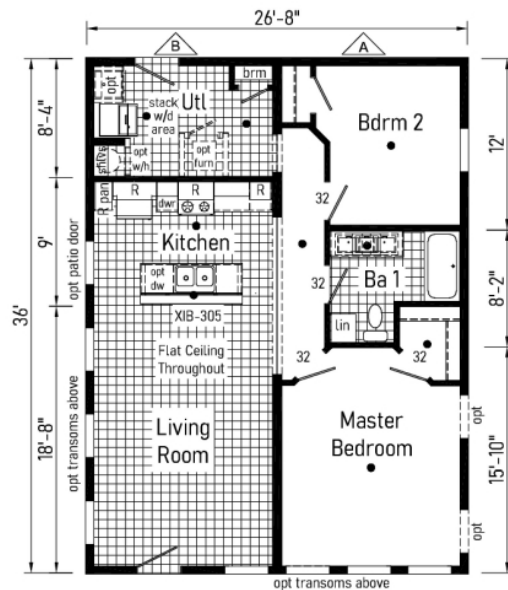

### Westlake Retreat 3WM1643-P 2836 Approx. 960 Sq. Ft. Optional Stairwell Not Available

Note: Optional furnace not available with fixed cathedral trusses.

- = Hitch end of home and box label
- = Std. 30/36 staggered overhead
- = Std. can light

#### Optional Prow End

(only available w/cathedral ceiling)

Note: Prow End is not available at hitch end of home.

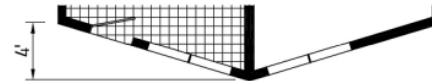

Note: Because of varying state requirements and optional equipment, some or all of the utility locations might change per floor plan (ie: furnaces, w/h, stairwell). Consult your sales representative for exact specifications.

Builder: midcountry Homes	Address: 337 Liberty Street Dorchester, WI 54425	Callout: 2836	Revisions:	Scale: 1/8" = 1'-0"	Date: 12/13/2023	Cust: -	Model/Eng. No: 3WM1643-P
Title: Literature			Drawn By: KH	Reference: NONE	S/N: .	Dir: -	LIT
						Pg: .	

## About This Model

Style: MOD / Bedrooms: 2 / Bathrooms: 1 / Square Feet: 960

## CUSTOMER CONTACT

Notes:

---



---



---



---

## PRINTABLE INFO SHEET

**Series: Westlake MOD**

**Model: 3WM1643-P**



## Standards & Features

### Interior

Primed Drywall Throughout Orange Peel Finish  
8'-0" Flat Ceiling Orange Peel Finish  
Recessed LED Lights  
Pendant Dining Room Light  
2-Panel White Painted Craftsman Interior Doors  
Pre-Hung Doors with Mortise Hinges  
Metal Interior Passage Sets  
Window Valances  
1" Mini Blinds Throughout  
Smoke Detectors with Battery Back-Up  
Wire Shelving in Closets  
White Painted Mouldings Throughout  
Flat 2 1/4" Window and Door Casing  
Flat 3 1/2" Baseboards  
Cove Moulding

### Exterior

Black Gatsby Light at Front and Rear Door  
Vinyl Dutch Lap Siding  
Double Low-E Vinyl Insulated Windows - Mulled w/ Argon  
Lineals Front Door Side  
GFI-Protected Exterior Receptacle Each Door  
O.S.B. Wall and Roof Sheathing  
Fixed Roof  
12" Overhangs and Eaves  
4" Overhangs and 12" Eaves (Single)  
3-Tab Shingles  
Ridge Vent Roof Ventilation System  
Ice Shield  
3/0x6/8 Fiberglass 6-Panel Front and Rear  
Door w/ Deadbolt Keyed Alike Locksets

### Exterior (continued)

Wind Wrap

### Kitchen

Cityscape Staggered Overhead Cabinetry  
Empire Brushed Nickel High Rise Faucet  
Stainless Steel Sink 33x22x8  
One USB Receptacle  
30" Black Free-Standing Gas or Electric Range  
Power Range Hood with Fan and Light  
18 Cu. Ft. Black Frost-Free Refrigerator w/Top Freezer

### Baths

60" Fiberglass Tub/Showers  
Tub/Shower Curtain and Curved Rod  
Dual Flush Elongated Hi-Rise Toilets  
Square China Sinks with Overflow and Pop-Up Drain  
Bevel Edge Mirrors  
Empire Brushed Nickel Faucets  
Structured Flow Anti-Scald Valves on Showers and Tubs

### Cabinetry

KCMA Certified Cabinets  
Hardwood Wrapped Mission Cabinet Doors with Full Overlay  
Hardwood Wrapped Cabinet Face Frames and Stiles  
5-Piece Drawer Fronts  
Brushed Nickel Cabinet Pulls Hardware  
Soft Close Hidden Cabinet Hinges  
Base and Wall Cabinets with Adjustable Shelves  
100# Undermount Soft Close Drawer Guides  
Laminate Countertops with Crescent Edge  
4" Laminate Backsplash  
36" High Vanities

## CUSTOMER CONTACT

Notes:

---

---

---

---

## PRINTABLE INFO SHEET

**Series: Westlake MOD**

**Model: 3WM1643-P**



## Standards & Features (continued)

### Utilities

200 AMP Electrical Service  
Plumb and Wire for Washer  
Wire and Vent for Dryer  
Water Shut Offs Throughout  
Main Water Shut-Off  
One Exterior Water Faucet (Frost Free)  
Gas Lines Stubbed  
Drain Lines Stubbed  
5-Wire Thermostat  
Copper Wiring Throughout

### Insulation

Ceiling R-38 Avg. Blown Insulation  
Walls R-19 Fiberglass Insulation

### Flooring

Take Away Shaw Carpet with ShawGuard Carpet Protector  
Rebond Carpet Pad with Tackstrip Carpet Installation  
Shaw Vinyl Floor Coverings

### Bedrooms

Wire Shelving in Closets  
Switched Light in All Walk-In Closets

### Construction

2x10 Floor Joist, Double Rim Joists  
3/4" OSB Decking\*  
2x6 Bottom Plate  
Double 2x6 Top Plate Exterior Walls  
2x6 Exterior Walls 16" on Center\*\*  
82" Window Headers  
40# Roof Load  
2-10 Extended Warranty  
\*\*Spacing for Framing Members may vary

### Construction (continued)

due to Design Requirements

## CUSTOMER CONTACT

Notes:

---

---

---

---