

PRINTABLE INFO SHEET

Series: Westlake Sapphire
Model: 1W1407-V Sapphire



About This Model

Style: Single / Bedrooms: 3 / Bathrooms: 2 / Square Feet: 1140

CUSTOMER CONTACT

Notes:

PRINTABLE INFO SHEET

Series: Westlake Sapphire
 Model: 1W1407-V Sapphire



Floorplan

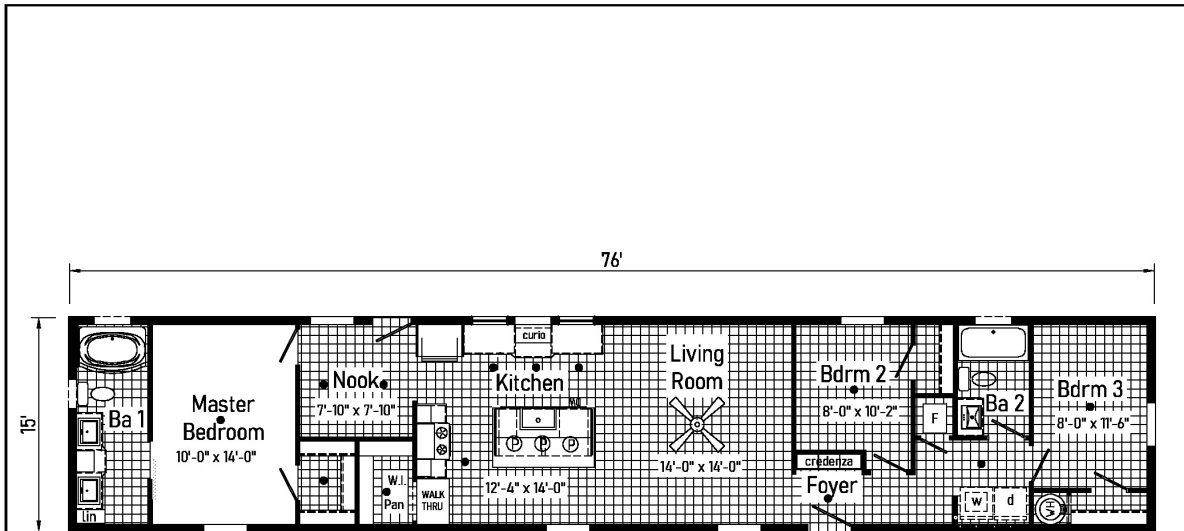

1W1407-V 1676 Approx. 1140 Sq. Ft.

Westlake Sapphire

Builder: midcountry Homes	Address: 337 Liberty Street Dorchester, WI 54425	Callout: 1676	Revisions:	Scale: 1"=0" = 1'-0"	Date:	Cust: -	Model/Eng. No.: 1W1407-V LITZ
Title: Literature			Drawn By:	Reference: NONE	Dir: -	S/N: -	Pg.:

N:\MIDCOUNTRY\1676-1W1407-V

CUSTOMER CONTACT

Notes:

PRINTABLE INFO SHEET

Series: Westlake Sapphire

Model: 1W1407-V Sapphire



Standards & Features

Interior

- Primed Drywall Throughout Orange Peel Finish
- 8'-0" Flat Ceiling Orange Peel Finish
- Recessed LED Lights
- Pendant Dining Room Light
- 2-Panel White Painted Craftsman Interior Doors
- Pre-Hung Doors with Mortise Hinges
- Metal Interior Passage Sets
- Window Valances
- 1" Mini Blinds Throughout
- Smoke Detectors with Battery Back-Up
- Wire Shelving in Closets
- White Painted Mouldings Throughout
- Flat 2 1/4" Window and Door Casing
- Flat 3 1/2" Baseboards

Exterior

- Black Gatsby Light at Front and Rear Door
- Vinyl Dutch Lap Siding
- Vinyl Insulated Windows with Low-E Glass
- Lineals Front Door Side
- GFI-Protected Exterior Receptacle at Each Door
- O.S.B. Wall & Roof Sheathing Fixed Roof
- 12" Overhangs and Eaves (Ranch)
- 4" Overhangs and 12" Eaves (Single)
- 3-Tab Shingles
- Ridge Vent Roof Ventilation System
- Ice Shield
- 3/0x6/8 Fiberglass 6-Panel Front and Rear
- Door w/ Deadbolt Keyed Alike Locksets

Construction

- Transverse Floor System on 16" Centers*

Construction (continued)

- 3/4" OSB Decking*
- 2x6 Floor Joist on 14 and 28 Wide Models
- 2x8 Floor Joists on 16 and 32 Wide Models
- 2x6 Exterior Walls on 16" Centers*
- 82" Window Headers
- 30# Roof Load

Kitchen

- Empire Brushed Nickel High Rise Faucet
- Stainless Steel Sink 33x22x8
- One USB Receptacle
- 30" Black Free-Standing Gas Range
- Power Range Hood with Fan and Light
- 18 Cu. Ft. Black Frost-Free Refrigerator w/Top Freezer

Baths

- 60" Fiberglass Tub/Shower Tub/Shower Curtain and Curved Rod
- Dual Flush Elongated Hi-Rise Toilets
- China Stool, Tank, and Lid
- Square China Sinks with Overflow and Pop-Up Drain
- Bevel Edge Mirrors
- Empire Brushed Nickel Faucets
- Anti-Scald Valves on Showers and Tubs

Cabinetry

- KCMA Certified Cabinets
- Hardwood Wrapped Mission Cabinet Doors with Full Overlay
- Hardwood Wrapped Cabinet Face Frames and Stiles
- 5-Piece Drawer Fronts
- Brushed Nickel Cabinet Pulls Hardware
- Soft Close Hidden Cabinet Hinges
- Base & Wall Cabinets with Adjustable Shelves

CUSTOMER CONTACT

Notes:

PRINTABLE INFO SHEET

Series: Westlake Sapphire
Model: 1W1407-V Sapphire



Standards & Features (continued)

Cabinetry (continued)

100# Undermount Soft Close Drawer Guides
Laminate Countertops with Crescent Edge
4" Laminate Backsplash
36" High Vanities

Bedrooms

Wire Shelving in Closets
Switched Light in All Walk-In Closets

Flooring

Take Away Shaw Carpet with ShawGuard Carpet Protector
Rebond Carpet Pad with Tackstrip Carpet Installation
Shaw Vinyl Floor Coverings

Utilities

100 AMP Electrical Service
Plumb and Wire for Washer
Wire and Vent for Dryer
Water Shut Offs Throughout
Main Water Shut-Off
One Exterior Water Faucet (Frost Free)
30 Gallon Electric Water Heater with Pan
Gas Furnace
5-Wire Thermostat
Copper Wiring Throughout

Insulation

Ceiling R-30 Avg. Blown Insulation
Walls R-19 Fiberglass Insulation
Floor R-11 Fiberglass Insulation

Items in bold are the Sapphire Additional Features

8'-0" Cathedral Ceiling (Multi Sections)

Skyview Wall with Transoms
Ceiling Fan in Living Room

8'-0" Cathedral Ceiling (Multi Sections) (continued)

Foyer Accent Cabinet and Wall
3 Pendant Lights over Island
Pearl Appliance Package Stainless Steel Gas
Stainless Steel Over the Range Microwave
Full Ceramic Backsplash on Range Wall
Sliding Interior Door in Nook
Additional LED Lights in Nook
Accent Cabinet
30" Galley Sink w/ Spring Pull Out Faucet
Garden Tub/Shower in Master Bath
Double Sinks in Master Bath
2 Light Bath Fixtures Over Lav Mirrors
Accent Cabinet

****Spacing for Framing Members may vary due to Design Requirements**

CUSTOMER CONTACT

Notes:
